

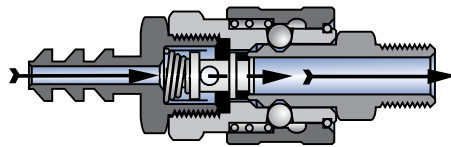

Acoples



Acoplado



Desacoplado

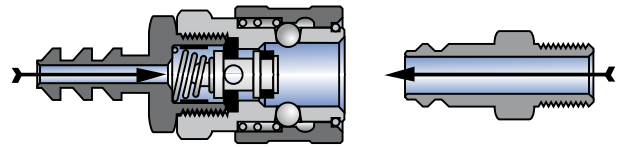

PRESIÓN DE USO:	
1/4"	15 Kgr/cm ²
3/8"	14 Kgr/cm ²
1/2"	12 Kgr/cm ²

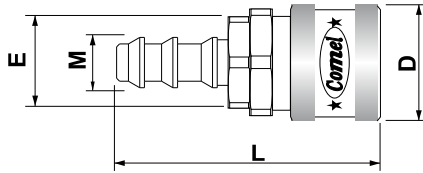

CUERPO ESCALONADO PARA MANGUERA					
CODIGO	PIEZA	L	D	E	M
5.10.31	ACE - 1/4"	62.5	28	22	8.5
5.10.40	ACE - 1/4"x5/16"	63	28	22	10.2
5.10.51	ACE - 3/8"	80	35	28	12
5.10.71	ACE - 1/2"	85.5	38	32	15

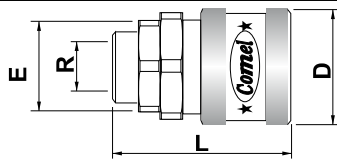

CUERPO ROSCA HEMBRA					
CODIGO	PIEZA	L	D	E	R
5.10.32	ACH - 1/4"	53.5	28	22	BSP-1/4"
5.10.52	ACH - 3/8"	69.0	35	28	BSP-3/8"
5.10.72	ACH - 1/2"	73.5	38	32	BSP-1/2"

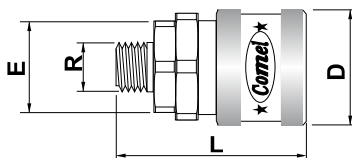

CUERPO ROSCA MACHO					
CODIGO	PIEZA	L	D	E	R
5.10.33	ACM - 1/4"	56.5	28	22	BSP-1/4"
5.10.53	ACM - 3/8"	73.5	35	28	BSP-3/8"
5.10.73	ACM - 1/2"	74.5	38	32	BSP-1/2"

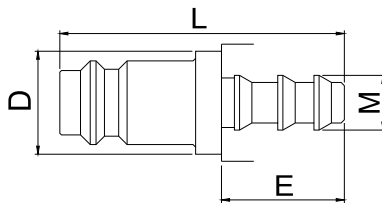

NIPLE ESCALONADO PARA MANGUERA					
CODIGO	PIEZA	L	E	D	M
5.10.27	ANE - 1/4"	45.0	19	16	8.5
5.10.30	ANE - 1/4"x5/16"	45.0	19	16	10.2
5.10.35	ANE - 1/4"x3/8"	46.5	21	16	12
5.10.36	ANE - 1/4"x1/2"	54.0	27	18	15
5.10.46	ANE - 3/8"x1/4"	59.0	24	19	7.5
5.10.55	ANE - 3/8"x5/16"	54.0	19	20.5	10.2
5.10.47	ANE - 3/8"	56.5	21.5	20	12
5.12.67	XNE - 3/8" x 1/2"	62.0	27	20	15
5.10.70	ANE - 1/2"x1/4"	54.0	19	23	8.5
5.10.83	ANE - 1/2"x3/8"	56.5	21.5	24	12
5.10.67	ANE - 1/2"	60.0	27	24	15

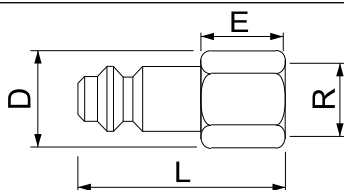

NIPLE ROSCA HEMBRA					
CODIGO	PIEZA	L	E	D	R
5.10.28	ANH - 1/4"	37.0	16	18	BSP-1/4"
5.10.48	ANH - 3/8"	50.0	21	22	BSP-3/8"
5.12.68	XNH - 3/8" x 1/2"	50.0	21	27	BSP-1/2"
5.10.68	ANH - 1/2"	50.0	21	27	BSP-1/2"

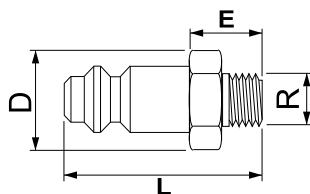

NIPLE ROSCA MACHO					
CODIGO	PIEZA	L	E	D	R
5.10.25	ANM - 1/4"x1/8"	39	18	16	BSP-1/8"
5.10.29	ANM - 1/4"	40	19	16	BSP-1/4"
5.10.37	ANM - 1/4"x3/8"	44	23	19	BSP-3/8"
5.10.38	ANM - 1/4"x1/2"	45	24	22	BSP-1/2"
5.10.82	ANM - 3/8"x1/4"	50	21	19	BSP-1/4"
5.10.49	ANM - 3/8"	53	24	19	BSP-3/8"
5.12.69	XNM - 3/8" x 1/2"	53	24	22	BSP-1/2"
5.10.69	ANM - 1/2"	53	24	22	BSP-1/2"
5.10.81	ANM - 1/2"x1/4"	49	20	22	BSP-1/4"
5.10.75	ANM - 1/2"x3/8"	52	23	22	BSP-3/8"

Adaptador B

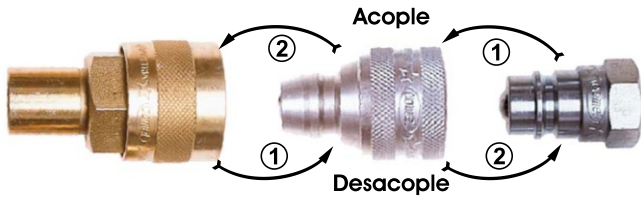

Adaptador J

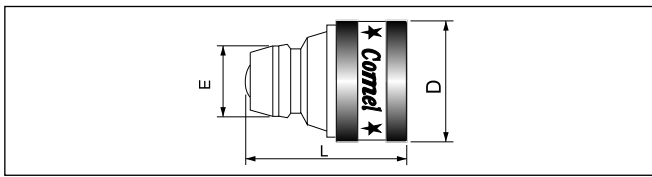
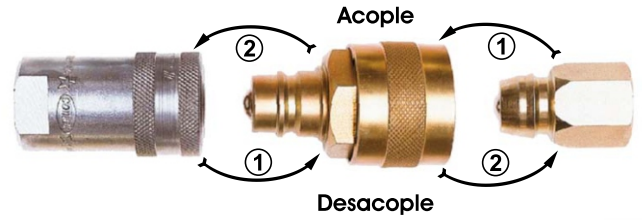

ADAPTADOR "B"					
CODIGO	PIEZA	MAT.	E	D	L
5.41.52	ADAPTADOR "B"	ACERO	24.7	38.2	57.0

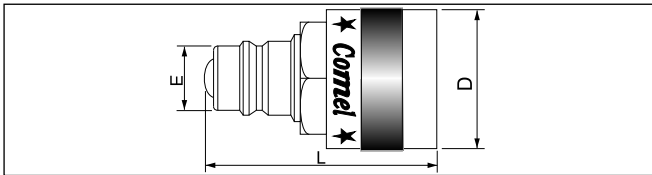

ADAPTADOR "J"					
CODIGO	PIEZA	MAT.	E	D	L
5.41.54	ADAPTADOR "J"	ACERO	23.7	44.0	72.0



TRACTOR - IMPLEMENTO AGRÍCOLA

PRESIÓN DE USO:	
3/8"	260 Kgr/cm ²
1/2"	250 Kgr/cm ²

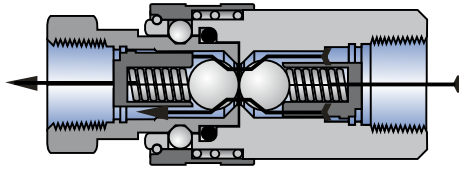
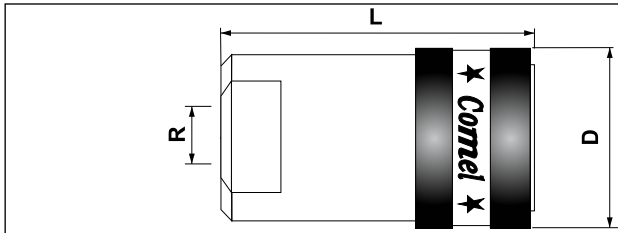
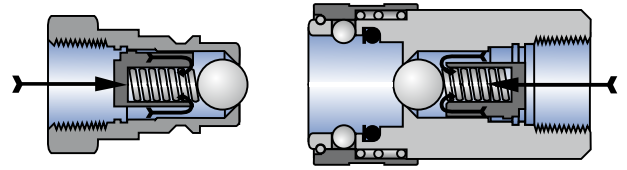
Acoplado

Desacoplado

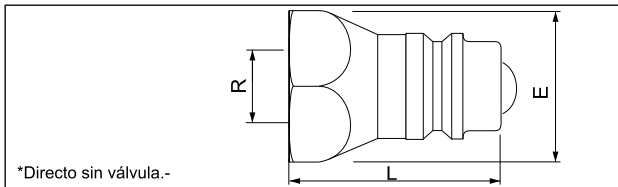
CUERPO ROSCA HEMBRA					
CODIGO	PIEZA	D	L	R	
5.21.11	BCH - 3/8"	35	67.0	3/8" - NPT	
5.22.51	BCH - 1/2"	38	68.3	1/2" - NPT	
5.22.52	BCH - 1/2" x 3/4"	38	68.3	3/4" - UNF	
5.22.53	BCH - 1/2" x M22-1.5	38	68.3	M-22 x 1.5	
5.91.14*	SCB - 1/2"	35	68.3	1/2" NPT	

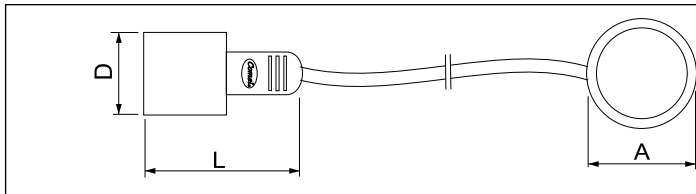

*Directo sin válvula.-

NIPLE ROSCA HEMBRA					
CODIGO	PIEZA	E	L	Bolita	R
5.21.13	BNH - 3/8" - NPT	24	41	3/8"	3/8" - NPT
5.22.67	BNH - 1/2" - NPT	27	46	17/32"	1/2" - NPT
5.22.68	BNH - 1/2" x 3/4	27	46	17/32"	3/4" - UNF
5.91.16*	SNB - 1/2"	27	46	-	1/2" NPT



TAPA					
CODIGO	PIEZA	MAT.	A	D	L
5.21.16	BTH - 3/8"	ACERO	33	28	40.0
5.22.75	BTH - 1/2"	ACERO	33	32	36.5
5.22.81	BTHP - 1/2"	PLÁST.	33	27.3	50.0
5.22.83	BTHG - 1/2"	NBR	33	27.3	50.0

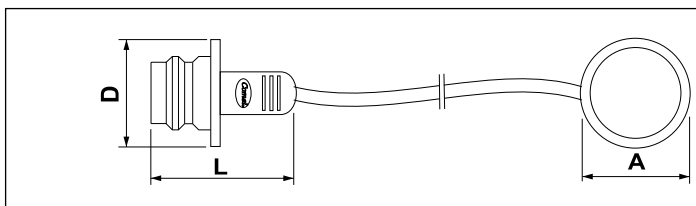

TAPON					
CODIGO	PIEZA	MAT.	A	D	L
5.21.18	BTM - 3/8"	ACERO	33	21.0	27.0
5.22.79	BTM - 1/2"	ACERO	33	23.8	25.8
5.22.82	BTMP - 1/2"	PLÁST.	33	23.6	47.0
5.22.84	BTMG - 1/2"	NBR	33	23.6	47.0

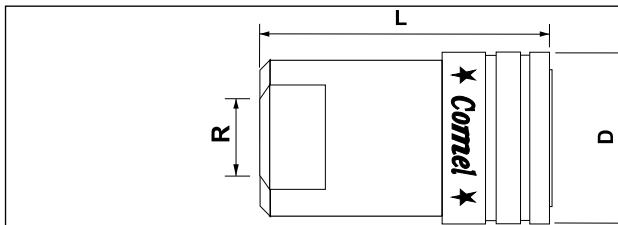

CUERPO ROSCA HEMBRA ZANELLO				
CODIGO	PIEZA	L	D	R
5.22.65	BCH - 1/2" - Z	68.3	42	1/2" - NPT

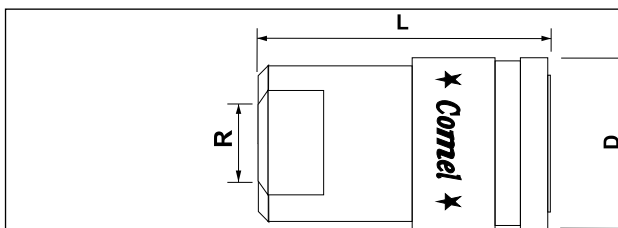

CUERPO ROSCA HEMBRA FIAT				
CODIGO	PIEZA	L	D	R
5.22.70	BCH - 1/2" - F	68.3	38	3/4" - UNF
5.22.71	BCH - 1/2" - F	68.3	38	1/2" NPT

	CUERPO ROSCA HEMBRA JOHN DEERE				
	CODIGO	PIEZA	L	D	R
	5.22.66	BCH - 1/2" - J	68.3	38	3/4" - UNF

	CUERPO ROSCA HEMBRA DEUTZ				
	CODIGO	PIEZA	L	D	R
	5.22.72	BCH - 1/2" - D	68.3	38	M-22 - 1.5

	CUERPO ROSCA HEMBRA MASSEY FERGUSON				
	CODIGO	PIEZA	L	D	R
	5.22.73	BCH - 1/2" - MF	68.3	42	3/4" - UNF

	CUERPO ROSCA HEMBRA RAYADO P/SEGUER				
	CODIGO	PIEZA	L	D	R
	5.22.69	BCH - RS - 1/2"	69	38	NPT - 1/2"

	CUERPO ROSCA HEMBRA AUTOMATICO				
	CODIGO	PIEZA	L	D	R
	5.24.55	BCA - 1/2" - NPT	68.3	38	1/2" - NPT
	5.24.57	BCA - M 22 x 1.5	68.3	38	M-22 - 1.5
	5.24.58	BCA - 3/4" - UNF	68.3	38	3/4" - UNF

	SOPORTE DUPLEX COMPLETO				
	CODIGO	PIEZA	DESIGNACIÓN	D	L
	5.22.94	BDO - 1/2"	SOPORTE DUPLEX	8.90	83

* Este conjunto incluye Aros Seguros

SERVICIOS HIDRÁULICOS, MÁQUINAS VIALES Y AGRÍCOLAS

PRESIÓN DE USO:	
3/4"	150 Kgr/cm ²
1"	100 Kgr/cm ²
1" 1/4	80 Kgr/cm ²
1" 1/2	50 Kgr/cm ²
2"	25 Kgr/cm ²
2" 1/2	20 Kgr/cm ²
3"	20 Kgr/cm ²

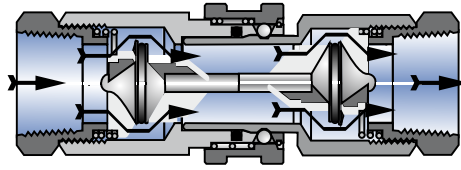
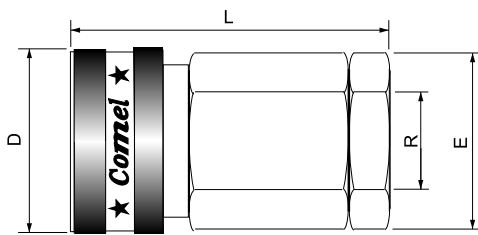
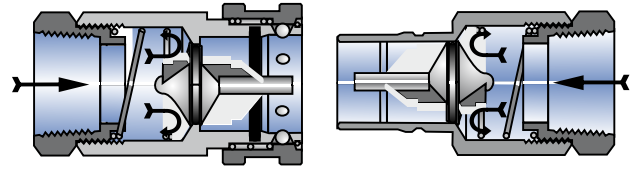
Acoplado

Desacoplado

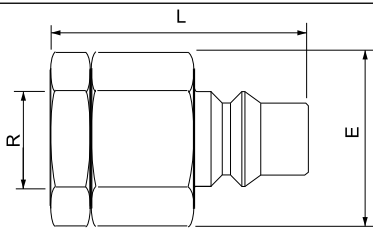
CUERPO ROSCA HEMBRA					
CODIGO	PIEZA	L	D	E	R
5.31.08	ECH - 3/4"	78.5	46.0	38.0	NPT-3/4"
5.31.23	ECH - 1"	85.0	54.0	46.0	NPT-1"
5.31.38	ECH - 1.1/4"	101.0	62.0	50.8	NPT-1.1/4"
5.31.58	ECH - 1.1/2"	125.2	77.5	60.5	NPT-1.1/2"
5.31.75	ECH - 2"	152.5	105.0	95.0	NPT-2"
5.31.88	ECH - 2.1/2"	152.5	105.0	95.0	NPT-2.1/2"

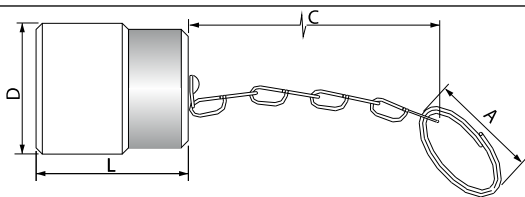

NIPLE ROSCA HEMBRA				
CODIGO	PIEZA	L	E	R
5.31.10	ENH - 3/4"	76.0	38.0	NPT-3/4"
5.31.25	ENH - 1"	83.0	46.0	NPT-1"
5.31.40	ENH - 1.1/4"	102.0	50.8	NPT-1.1/4"
5.31.60	ENH - 1.1/2"	124.5	60.5	NPT-1.1/2"
5.31.76	ENH - 2"	151.5	95.0	NPT-2"
5.31.90*	ENH - 2.1/2"	151.5	95.0	NPT-2.1/2"

* Se ofrece la alternativa de extremo con rosca NPT - 3"



TAPA					
CODIGO	PIEZA	L	D	C	A
5.31.12	ETH - 3/4"	40	35.0	170	33
5.31.27	ETH - 1"	44	44.4	170	33
5.31.42	ETH - 1.1/4"	49	51.0	170	33
5.31.92	ETH - 2.1/2"	71	82.0	170	33

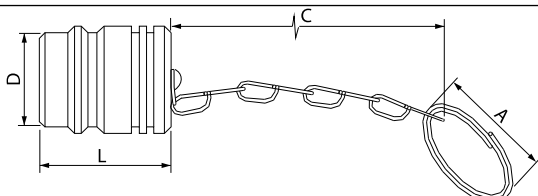

TAPON					
CODIGO	PIEZA	L	D	C	A
5.31.14	ETM - 3/4"	33.0	26.4	170	33
5.31.29	ETM - 1"	35.0	44.4	170	33
5.31.44	ETM - 1.1/4"	37.0	51.0	170	33
5.31.94	ETM - 2.1/2"	75.5	82.0	170	33

ACEITES - COMBUSTIBLES - GASES - AGUA Y VAPOR

Acoplado

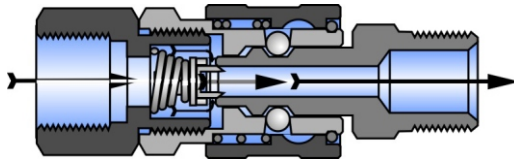

Desacoplado

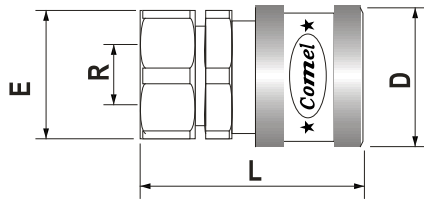
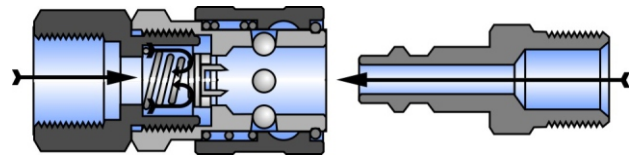

CUERPO ROSCA HEMBRA

CODIGO	PIEZA	L	D	E	R
5.16.01	FCH - 1/8"	52	25.5	19.0	NPT-1/8"
5.16.02	FCH - 1/4"	52	25.5	19.0	NPT-1/4"
5.16.03	FCH - 3/8"	55	25.5	20.6	NPT-3/8"
5.16.04*	FSH - 1/8"	52	25.5	19.0	NPT-1/8"
5.16.05*	FSH - 1/4"	52	25.5	19.0	NPT-1/4"
5.16.06*	FSH - 3/8"	55	25.5	20.6	NPT-3/8"

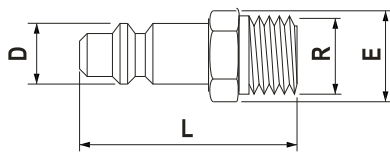

NIPLE ROSCA MACHO*

CODIGO	PIEZA	L	D	E	R
5.16.07	FNM - 1/8"	40.5	10.5	12.7	NPT-1/8"
5.16.08**	FNM - 1/4"	44.5	10.5	14.0	NPT-1/4"
5.16.09**	FNM - 3/8"	44.6	10.5	19.0	NPT-3/8"

* Sin válvula.

** Este niple se fabrica también con válvula de retención.



ACEITES Y GRASAS - AIRE COMPRIMIDO - GASES - PINTURA Y VAPOR

PRESIÓN DE USO:	
1/2"	250 Kgr/cm ²

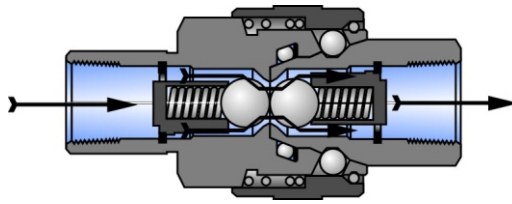
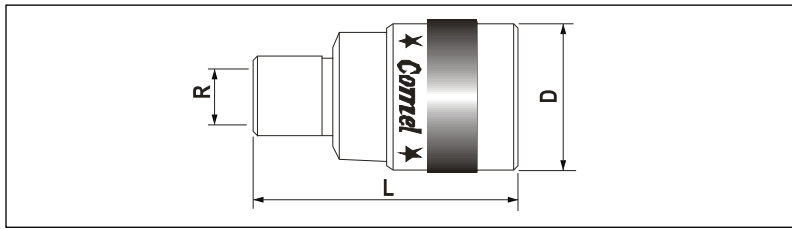
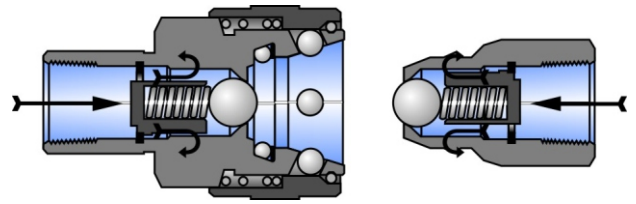
Acoplado

Desacoplado

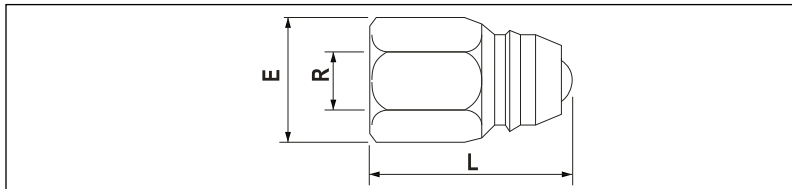
CUERPO ROSCA HEMBRA				
CODIGO	PIEZA	L	D	R
5.41.30	JDC - 1/2"	77	44.5	3/4" - UNF-16-2B

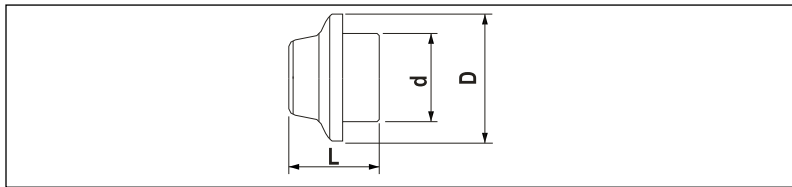

NIPLE ROSCA HEMBRA				
CODIGO	PIEZA	L	E	R
5.41.10	JDN - 1/2"	50	27	1/2" - NPT
5.41.20	JDN - 1/2" x 3/4"	50	27	3/4" - UNF-16-2B



TAPA				
CODIGO	PIEZA	d	D	L
5.41.38	JDTH - 1/2"	34	44.5	27

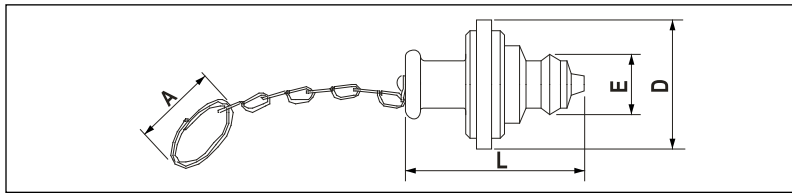

TAPON					
CODIGO	PIEZA	L	D	E	A
5.41.39	JDTM - 1/2"	57	45.5	22	33

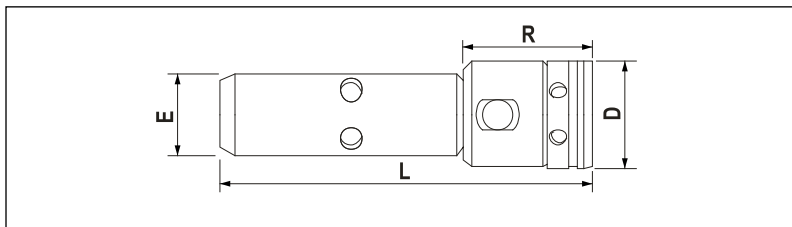

CUERPO PARA CONJUNTO DOBLE					
CODIGO	PIEZA	L	D	E	F
5.41.50	JCL - 1/2"	116	34.2	25.4	39

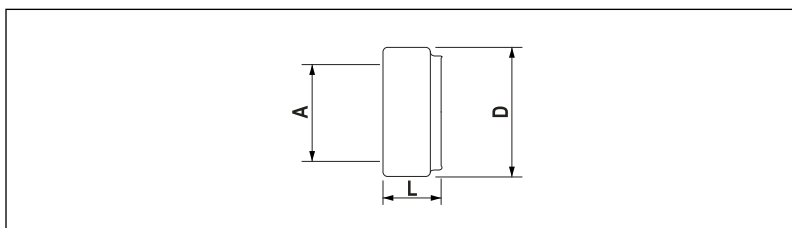

MANGUITO				
CODIGO	PIEZA	L	D	A
3.41.42	JDC - 1/2"-22	21	43.5	34.4

PRESIÓN DE USO:	
1/4"	280 Kgr/cm ²
3/8"	260 Kgr/cm ²
1/2"	250 Kgr/cm ²
3/4"	200 Kgr/cm ²

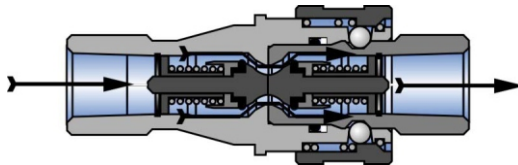
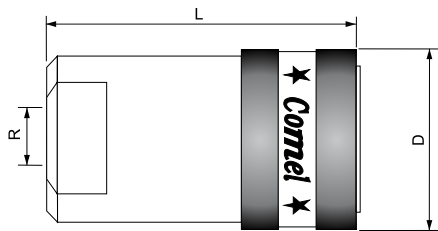
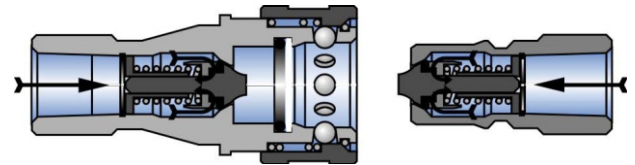
Acoplado

Desacoplado

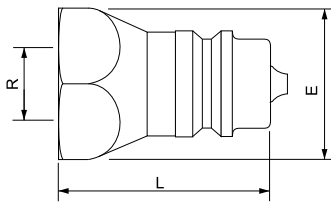
CUERPO ROSCA HEMBRA

CODIGO	PIEZA	L	D	R
5.81.23*	PCH - 1/4" PKR	58.5	28.6	NPT - 1/4"
5.81.27	PCH - 1/4"	58.5	28.6	NPT - 1/4"
5.81.35	PCH - 3/8"	67.0	35.0	NPT - 3/8"
5.81.54	PCH - 1/2"x3/4"	69.0	38.0	UNF - 3/4"
5.81.55	PCH - 1/2"	69.0	38.0	NPT - 1/2"
5.81.69	PCH - 3/4"	88.4	55.5	NPT - 3/4"

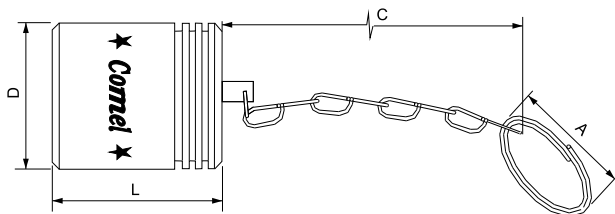
NIPLE ROSCA HEMBRA

CODIGO	PIEZA	L	E	R
5.81.24*	PNH - 1/4" PKR	36	19	NPT - 1/4"
5.81.30	PNH - 1/4"	36	198	NPT - 1/4"
5.81.50	PNH - 3/8"	43	24	NPT - 3/8"
5.81.58	PNH - 1/2"	46	27	NPT - 1/2"
5.81.60	PNH - 1/2"x3/4"	46	27	UNF - 3/4"
5.81.72	PNH - 3/4"	59	35	NPT - 3/4"

TAPA

CODIGO	PIEZA	L	D	C	A
5.81.33	PTH - 1/4"	28	20.6	170	33
5.81.75	PTH - 3/4"	40	44.5	170	33

* Intercambiable con marca Parker

CIRCUITOS HIDRÁULICOS

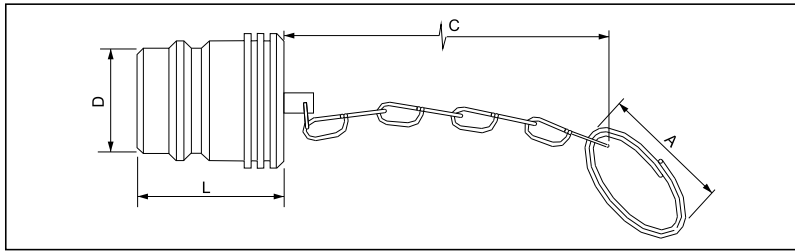

TAPON					
CODIGO	PIEZA	L	D	C	A
5.81.34	PTM - 1/4"	21	14.4	170	33
5.81.76	PTM - 3/4"	42	31.0	170	33

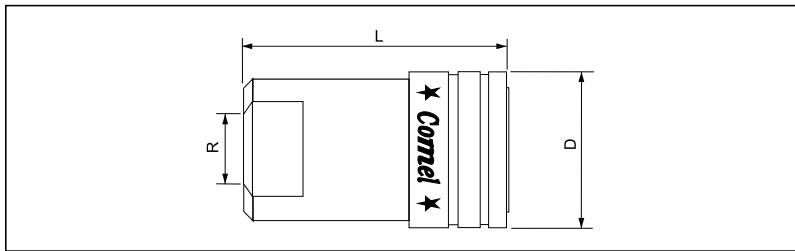

CUERPO ROSCA HEMBRA ZANELLO				
CODIGO	PIEZA	L	D	R
5.81.57	PCH - Z - 1/2"	69	42	NPT - 1/2"

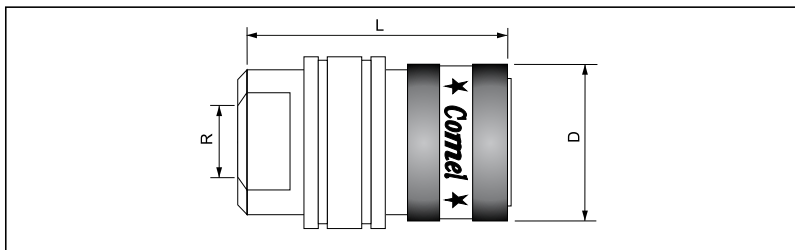

CUERPO ROSCA HEMBRA PAUNY				
CODIGO	PIEZA	L	D	R
5.81.61	PCH - Pauny 1/2"	69	42	NPT - 1/2"

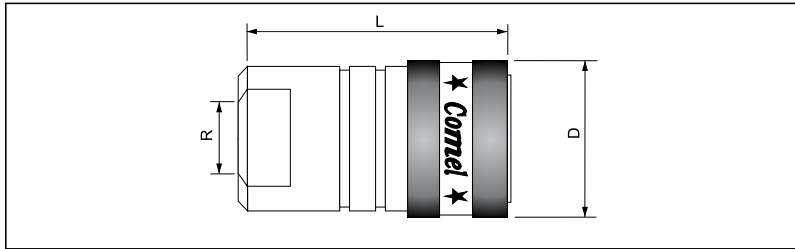

CUERPO ROSCA HEMBRA RAYADO P/SEGUER				
CODIGO	PIEZA	L	D	R
5.81.81	PCH - RS - 1/2"	69	38	NPT - 1/2"

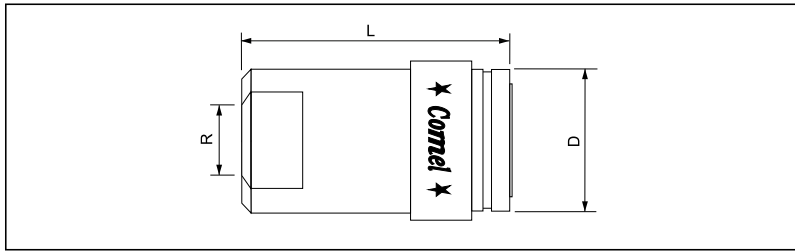

CUERPO ROSCA HEMBRA OMAR MARTIN				
CODIGO	PIEZA	L	D	R
5.81.82	PCH - OM - 1/2"	69	42	NPT - 1/2"

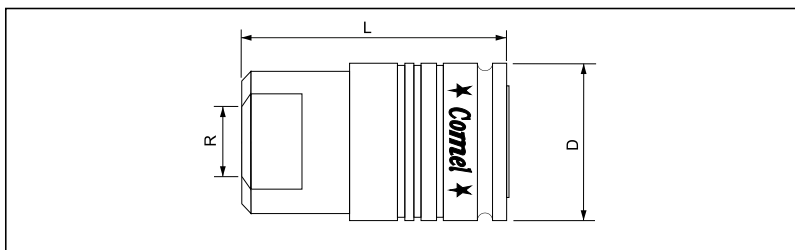

CUERPO ROSCA HEMBRA AUTOMATICO				
CODIGO	PIEZA	L	D	R
5.83.86	PCA - 1/2"	69	38	NPT - 1/2"
5.83.87	PCA - M22x1.5"	69	38	M 22 X 1.5
5.83.88	PCA - 1/2" x 3/4"	69	38	UNF - 3/4"

CIRCUITOS HIDRÁULICOS

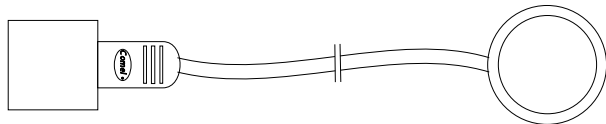
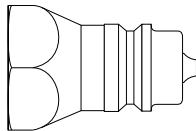
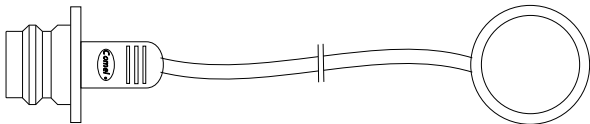
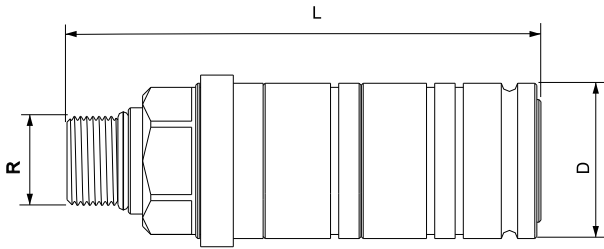

5.83.62 Conjunto Reparación John Deere 7500 - New Holland TM 150

CODIGO	PIEZA
--------	-------

5.83.59	PCA 1/2" Cuerpo RM M22x1.5
	R: M 22 x 1.5, L: 115, D: 38

5.81.58	PNH 1/2" Niple RH 1/2"NPT
---------	---------------------------

5.22.81	BTHP Tapa Plástica
---------	--------------------

5.22.82	BTMP Tapón Plástica
---------	---------------------

5.83.63 Conjunto Reparación John Deere 6500

CODIGO	PIEZA - DIMENSIONES
--------	---------------------

5.83.61	PCA 1/2" Cuerpo RM 7/8" UNF
	R: 7/8" UNF, L: 115, D: 38

5.81.58	PNH 1/2" Niple RH 1/2"NPT
---------	---------------------------

5.22.81	BTHP Tapa Plástica
---------	--------------------

5.22.82	BTMP Tapón Plástica
---------	---------------------

5.83.65 Conjunto Reparación Fiat

CODIGO	PIEZA - DIMENSIONES
--------	---------------------

5.83.60	PCA 1/2" Cuerpo RH 1/2"NPT
	R: 1/2"NPT, L: 127, D: 38

5.81.58	PNH 1/2" Niple RH 1/2"NPT
---------	---------------------------

5.22.81	BTHP Tapa Plástica
---------	--------------------

5.22.82	BTMP Tapón Plástica
---------	---------------------

5.83.66 Conjunto Reparación New Holland TM 125

CODIGO	PIEZA - DIMENSIONES
--------	---------------------

5.83.64	PCA 1/2" Cuerpo RH 1/2"NPT
	R: 1/2"NPT, L: 118, D: 38

5.81.58	PNH 1/2" Niple RH 1/2"NPT
---------	---------------------------

5.22.81	BTHP Tapa Plástica
---------	--------------------

5.22.82	BTMP Tapón Plástica
---------	---------------------

5.83.67 Conjunto Reparación Valmet

CODIGO	PIEZA - DIMENSIONES
--------	---------------------

5.83.68	PCA 1/2" Cuerpo RM 3/4" UNF
	R: 3/4" UNF, L: 111, D: 38

5.81.58	PNH 1/2" Niple RH 1/2"NPT
---------	---------------------------

5.22.81	BTHP Tapa Plástica
---------	--------------------

5.22.82	BTMP Tapón Plástica
---------	---------------------

CIRCUITOS HIDRÁULICOS

PRESIÓN DE USO:	
1/4"	280 Kgr/cm ²
1/2"	250 Kgr/cm ²

Acoplado

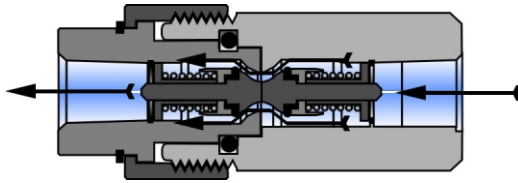

Desacoplado

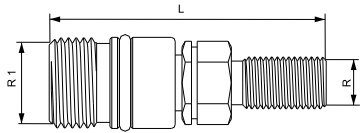
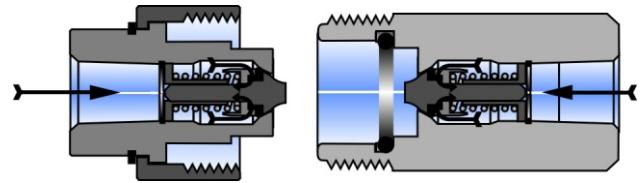

CUERPO ROSCA MACHO New Holland

CODIGO	PIEZA	L	R	R1
5.81.22	PCH-R NH - 1/4"	73	M 14x1.5	M 24x2

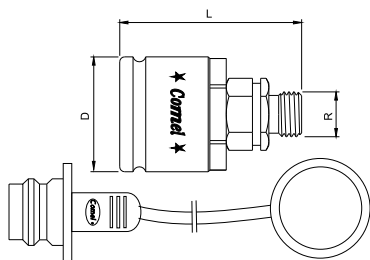

NIPLE ROSCA MACHO New Holland

CODIGO	PIEZA	L	R	D	
5.81.23	PCH-R 1/4" N.H.	56	M 14x1.5	35	

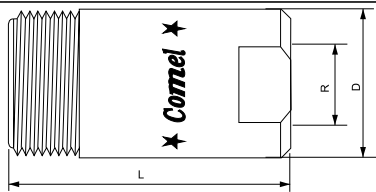

CUERPO ROSCA HEMBRA

CODIGO	PIEZA	L	D	R
5.81.28	PCH-R - 1/4"	56.5	25.3	1/4" - NPT
5.81.56	PCH-R - 1/2"	68.2	35.0	1/2" - NPT

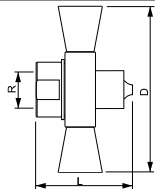

NIPLE ROSCA HEMBRA CON MARIPOSA

CODIGO	PIEZA	L	D	R
5.81.32	PNH-R - 1/4"	39	68.3	1/4" - NPT

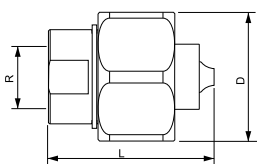

NIPLE ROSCA HEMBRA

CODIGO	PIEZA	L	D	R
5.81.31	PNH-R - 1/4"	39	31.5	1/4" - NPT
5.81.59	PNH-R - 1/2"	50	43.0	1/2" - NPT

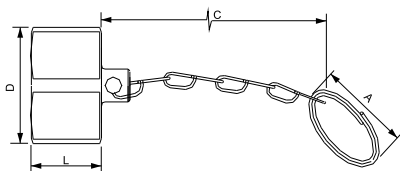

TAPA

CODIGO	PIEZA	L	D	C	A
5.81.25	PTH-R - 1/4"	17.0	31.5	170	33
5.81.63	PTH-R - 1/2"	30.0	38.0	170	33

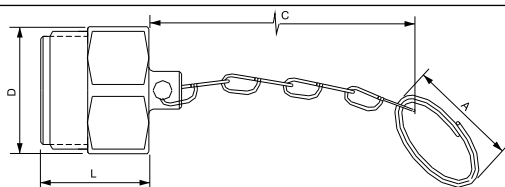

TAPON

CODIGO	PIEZA	L	D	C	A
5.81.26	PTM-R - 1/4"	23.5	30.0	170	33
5.81.64	PTM-R - 1/2"	30.0	38.0	170	33

PRESIÓN DE USO:	
1/2"	250 Kgr/cm ²
3/4"	250 Kgr/cm ²
1"	250 Kgr/cm ²

Acoplado

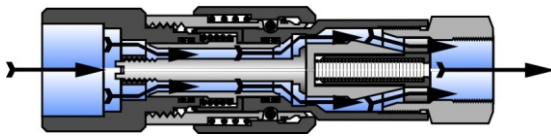

Desacoplado

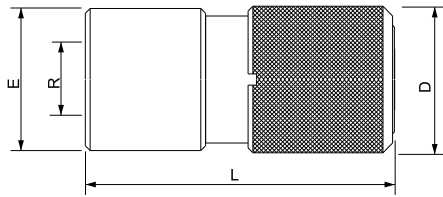
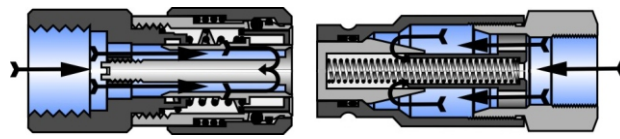

CUERPO ROSCA HEMBRA

CODIGO	PIEZA	D	E	L	R
5.01.51	UCH - 1/2"	30.6	27	64.0	1/2" - BSP
5.01.52	UCH - 3/4" x 1.1/16"	38.7	35	71.8	1.1/16" - UNF
5.01.53	UCH - 3/4" x 7/8"	38.7	35	71.8	7/8"-UNF-JIC 37
5.01.54	UCH - 3/4"	38.7	35	71.8	3/4" NPT
5.01.70	UCH - 1" x 1.1/16"	47.8	41.2	97.8	1.1/16" - UNF
5.01.71	UCH - 1"	47.8	41.2	97.8	1" NPT

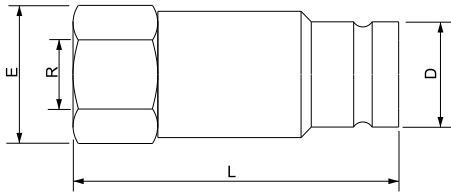

NIPLE ROSCA HEMBRA

CODIGO	PIEZA	D	E	L	R
5.01.13	UNH - 3/8"	19.7	25.4	61.5	3/8" - BSP
5.01.58	UNH - 3/4" x 1.1/16"	24.5	35.0	81.3	1.1/16"-UNF-"O"
5.01.59	UNH - 3/4" x 7/8"	24.5	35.0	81.3	7/8" - UNF-JIC 37
5.01.60	UNH - 3/4" NPT	24.5	35.0	81.3	3/4" - NPT
5.01.67	UNH - 1/2" NPT	19.7	27.0	65.0	1/2" - NPT
5.01.75	UNH - 1" x 1.1/16"	30.0	41.2	95.4	1.1/16"-UNF-"O"
5.01.76	UNH - 1" NPT	30.0	41.2	95.4	1" - NPT



INDUSTRIAS VIALES - PETROLERAS - MINERAS - EQUIPOS MÓVILES Y AGRÍCOLAS

PRESIÓN DE USO:	
1/4"	15 Kgr/cm ²
3/8"	14 Kgr/cm ²

Acoplado

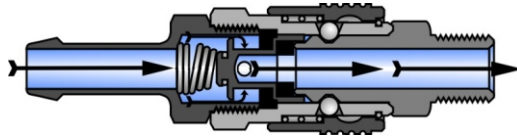

Desacoplado

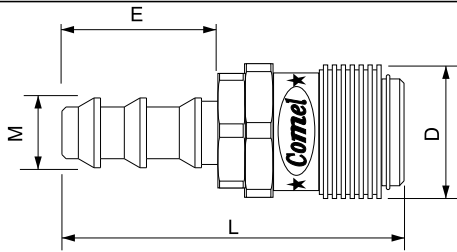
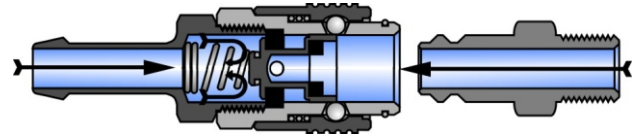

CUERPO ESCALONADO PARA MANGUERA					
CODIGO	PIEZA	L	D	E	M
5.12.31	XCE - 1/4"	62.7	25	19	8.5
5.12.40	XCE - 1/4" x 5/16"	62.6	25	19	10.2
5.12.38	XCE - 1/4" x 3/8"	64.8	25	19	12
5.12.39	XCE - 1/4" x 1/2"	70.7	25	19	15
5.12.51	XCE - 3/8"	75.3	25	24	12
5.12.71	XCE - 3/8" x 1/2"	81.2	25	24	15

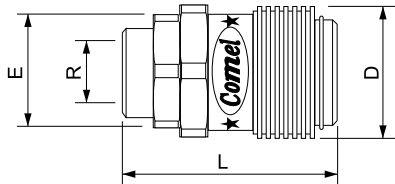

CUERPO ROSCA HEMBRA					
CODIGO	PIEZA	L	D	E	R
5.12.32	XCH - 1/4"	54.5	25.5	19	BSP-1/4"
5.12.52	XCH - 3/8"	67.0	32.0	24	BSP-3/8"
5.12.72	XCH - 3/8" x 1/2"	70.0	32.0	27	BSP-1/2"

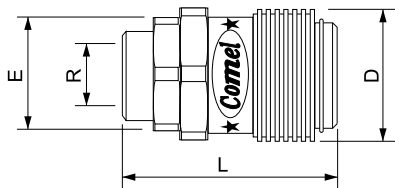

CUERPO ROSCA MACHO					
CODIGO	PIEZA	L	D	E	R
5.12.33	XCM - 1/4"	57.5	25.0	19	BSP-1/4"
5.12.43	XCM - 1/4" x 3/8"	59.5	25.0	19	BSP-3/8"
5.12.45	XCM - 1/4" x 1/2"	61.0	25.0	22	BSP-1/2"
5.12.53	XCM - 3/8"	68.0	32.0	24	BSP-3/8"
5.12.73	XCM - 3/8" x 1/2"	70.0	32.0	24	BSP-1/2"

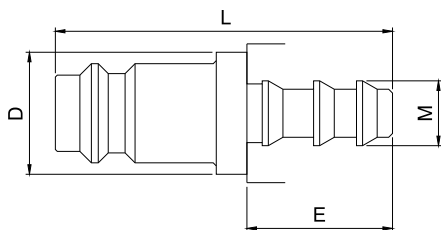

NIPLE ESCALONADO PARA MANGUERA					
CODIGO	PIEZA	L	E	D	M
5.10.27	ANE - 1/4"	45.0	19	16	8.5
5.10.30	ANE - 1/4"x5/16"	45.0	19	16	10.2
5.10.35	ANE - 1/4"x3/8"	46.5	21	16	12
5.10.36	ANE - 1/4"x1/2"	54.0	27	18	15
5.10.46	*ANE - 3/8"x1/4"	59.0	24	19	7.5
5.10.55	ANE - 3/8"x5/16"	54.0	19	20.5	10.2
5.10.47	ANE - 3/8"	56.5	21.5	20	12
5.12.67	XNE - 3/8" x 1/2"	62.0	27	20	15

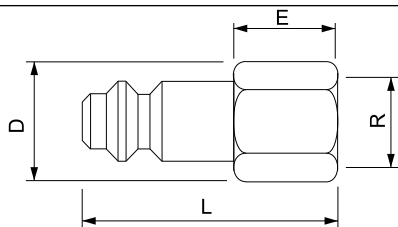

NIPLE ROSCA HEMBRA					
CODIGO	PIEZA	L	E	D	R
5.10.28	ANH - 1/4"	37.0	16	18	BSP-1/4"
5.10.48	ANH - 3/8"	50.0	21	22	BSP-3/8"
5.12.68	XNH - 3/8" x 1/2"	50.0	21	27	BSP-1/2"

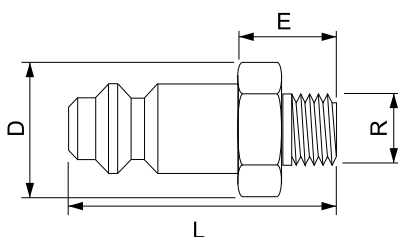

NIPLE ROSCA MACHO					
CODIGO	PIEZA	L	E	D	R
5.10.25	ANM - 1/4"x1/8"	39	18	16	BSP-1/8"
5.10.29	ANM - 1/4"	40	19	16	BSP-1/4"
5.10.37	ANM - 1/4"x3/8"	44	23	19	BSP-3/8"
5.10.38	ANM - 1/4"x1/2"	45	24	22	BSP-1/2"
5.10.82	ANM - 3/8"x1/4"	50	21	19	BSP-1/4"
5.10.49	ANM - 3/8"	53	24	19	BSP-3/8"
5.12.69	XNM - 3/8" x 1/2"	53	24	22	BSP-1/2"

AIRE COMPRIMIDO - GASES NO INFLAMABLES - LÍQUIDOS VARIOS - ACEITES - GRASAS